

Guide to Contour Paisley Accents

Carol A. Brown

Introduction

I like paisley designs and I like contour fills for embroidery designs. I added lines of decorative stitching to contour fill shapes to create two paisley designs. Paisley_A, shown here in blue, is available in two heights, 50 mm and 71 mm. The middle of the paisley is filled with stitches. Paisley_B, shown in purple, is open in the middle. It comes in the same two sizes.

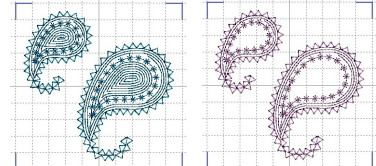

Paisley_A_50 & Paisley_A_71 Paisley_B_50 & Paisley_B_71

You can scatter a few paisleys to accent your Contour Script and Contour Fill designs. You can also create a frame, arranging the paisleys by eye. If your embroidery software provides a feature for arranging shapes in a frame, you can use that. Viking/Pfaff 4D Embroidery calls this feature Encore; other brands of software may have another name for it.

This design set includes 6 frames. I alternated Paisley_A and Paisley_B to create some of the frames. These designs have AB in their names. For the other frames, I first rotated Paisley_B 180° and then created the arrangements. ABU in a design name means that Paisley_B is upside down.

The first two frames fit in the 150 x 240 millimeter hoop. I used the smaller paisleys for these frames.

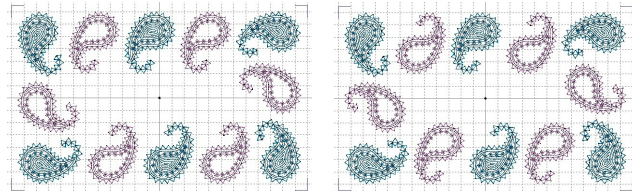

Paisley_AB_frame_150x240

Paisley_ABu_frame_150x240

The second two frames fit in the 200 x 260 millimeter hoop. I used the smaller paisleys for these frames, as well. This frame allows the most space in the middle for lettering.

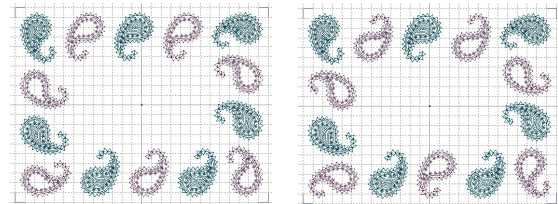

Paisley_AB_frame_200x260

Paisley_ABu_frame_200x260

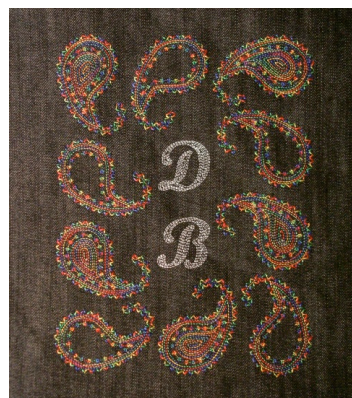

The final two frames also fit in the 200 x 260 millimeter hoop, but include the bigger paisleys. I have used this arrangement for framing a pair of initials. "DB" was quite pleased with it. I used Superior Rainbows #813 (my favorite!) for all the paisleys.

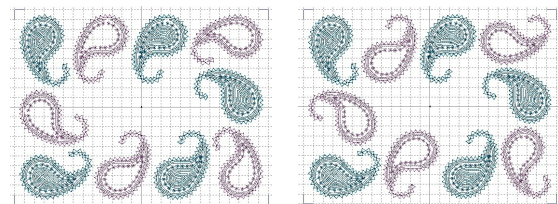

Paisley_AB_big_frame_200x260

Paisley_ABu_big_frame_200x260

I created two bands that fit in 100 x 170 and 130 x 180 millimeter hoops. There is not enough hoop space for a frame, but a band can be placed above or below lettering. You can also make a continuous border of paisleys by stitching more than one band in a line. Your software may offer an option to create alignment marks for continuous designs.

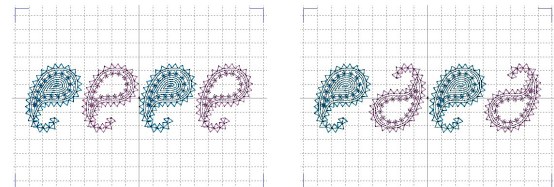

Paisley_AB_band_50x165

Paisley_ABu_band_50x165

For all the arrangements, I have sorted the colors so that Paisley_A stitches first. This makes the designs easy to stitch in two colors. If you want the paisleys all the same color, just turn off your color stop control and let your embroidery machine make a second trip around the hoop. If you have arranged your design so that any lettering in the middle is stitched first, you can turn off the color stop after you have changed to the thread for the paisleys. I recommend trimming the threads as you begin to stitch each paisley. If you can add jump trim commands, you can have your machine do the trimming.

