

# FUNKY GUEST TOWEL PILLOW INSTRUCTIONS



## Supplies

- 1 Guest Towel
- Coordinating thread or clear nylon thread
- 1 coordinating Gerber Daisy
- 1 pillowform or pillow stuffing

*Step 1:* Find the center point of your design and embroider.

*Step 2a:* Fold towel so that your top flap lines up horizontally with the bottom of the towel folded upwards (image 2a). You will want to make certain that they overlap just enough to stitch and keep closed.

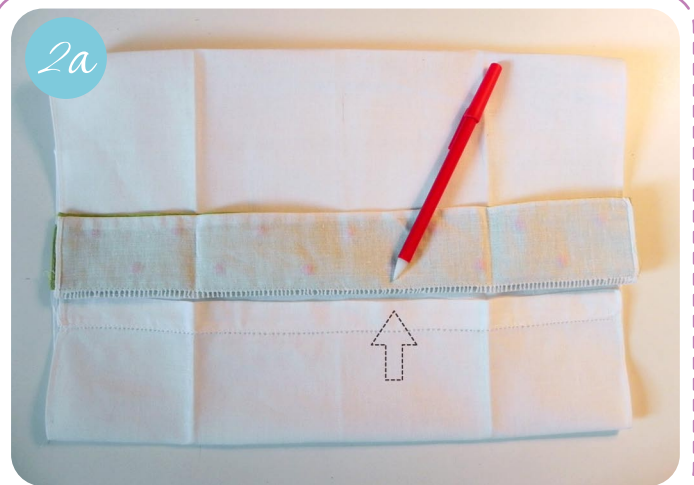

## FUNKY GUEST TOWEL PILLOW INSTRUCTIONS

*Step 2b:* Folded it should look like image 2b.



*Step 3:* Pin along the existing stitches just below the white satin stitch line. You will use this existing stitch line as your guide to stitch the front closed. I recommend using either clear transparent nylon thread or an identical match to the guest towel.

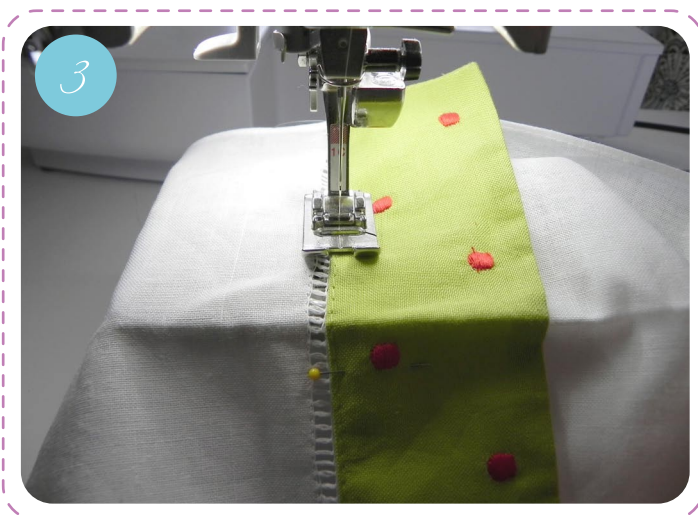

*Step 4:* Being very careful not to stitch through the back side of your pillow, using the existing stitch line as your guide, sew the front of your pillow closed. (Both sides will remain open for stuffing).

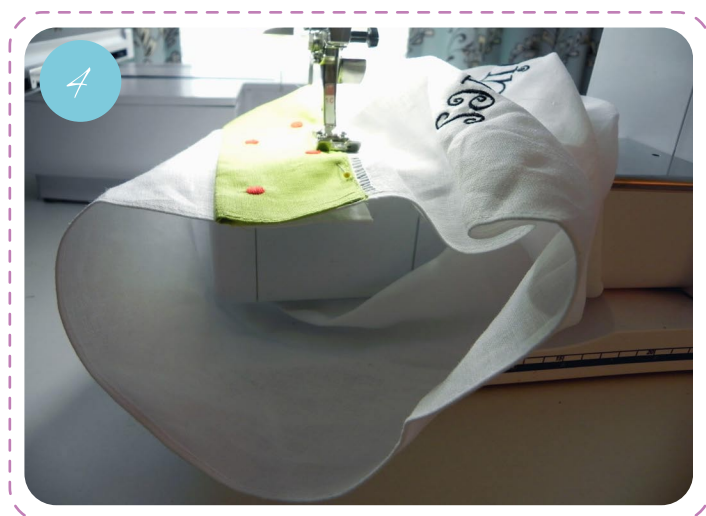

*Step 5a:* I recommend applying the daisy applique prior to filling and stitching closed. I used a simple \$2 daisy from Michaels. I snipped off the stem and removed the green plastic piece.



## FUNKY GUEST TOWEL PILLOW INSTRUCTIONS

*Step 5b:* I then stitched through the bottom 3 layers of the daisy so that my stitches would not be exposed.



*Step 6:* Stitch left vertical side closed using the existing stitch lines as your guide.

*Step 7:* Fill with stuffing - DO NOT overstuff, you will need to be able to push stuffing inside enough to stitch the right side closed.

*Step 8:* After stuffing, pin the other vertical side and stitch along the existing stitch line of the guest towel shown here.

